

## AMAZING DINOSAUR MODEL KIT

Diplodocus were one of the largest dinosaurs to ever walk the Earth over 150 million years ago. An adult could grow up to 33 metres long – that’s nearly three London buses together! ‘Dippy’ is 26m long and has stood in place at the Natural History Museum in London for over 100 years and is considered to be one of the world’s most famous dinosaurs. The skeleton cast was presented to the museum as a gift from the industrialist millionaire, Andrew Carnegie, back in 1905. In 2018, the museum’s beloved Diplodocus will travel the length and breadth of the country on his UK tour, before returning to his home at the museum.



Now build your own amazing model of ‘Dippy’ from these laser-cut wood pieces. Follow this step by step guide applying just a tiny amount of glue to each joint. If any joints are stiff, please don’t force them but use the sandpaper square to rub edges until they slide together. Some adult help may be needed.

When building, refer to this large picture to see more detail.



1 There are 10 wood sheets. Lay sheets 1-9 out in order. Sheet 10 is not numbered

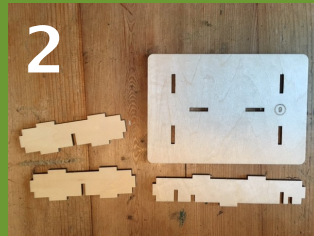

2 First take these four parts from sheets 7, 8 and 9. Push out the slots in sheet 9.

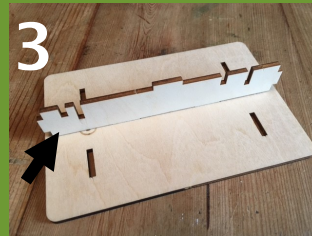

3 Slot two parts together like this. Make sure the double slot is on the left as in the picture.

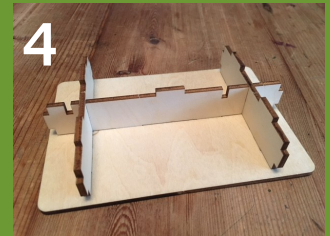

4 Now glue the two identical cross pieces into place.

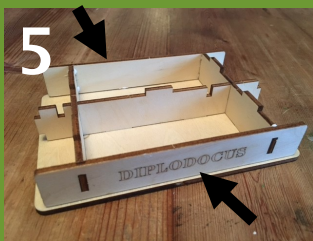

5 Take the two nameplates from sheet 6 and glue onto both sides of the plinth.



6 The two end pieces come from sheets 2 and 8.



7 Glue them into place on each end of the plinth.



8 Place tiny dots of glue around the top edge of the plinth.



9 Now push on sheet 10. It is important that the slots line up with those underneath.



10 Push in the supports from sheets 3 and 7. The lower one goes on the left.



11 Remove the four head parts from sheets 1, 3 and 5.



12 First glue these two parts together.





13 Then glue on the sides of the head.



14 Push out the spine and ten scales from sheets 2, 3 and 5.



15 Apply a little glue in the slots on the top of the spine.



16 Then slot the spines in like this.



17 Now join the head to the spine using this joint from sheet 1.



18 Take these two parts from sheet 3 and 5.



19 And join them onto the other end of the spine.

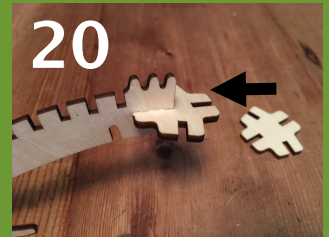

20 Carry on extending the body. Push on this part from sheet 4.



21 These next parts come from sheets 1 and 6.



22 Glue the scales in place with the largest on the left and smallest right.



23 Join the section you just built to the end of the spine.



24 The end tail piece comes from sheets 1 and the joint from 8.



25 Make the short front legs with three parts from sheets 4 and 7.



26 Slot the assembled front feet in under the body.

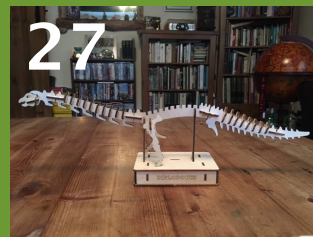

27 You can now sit the body and front legs on the two supports.



28 Assemble the tall back legs from sheets 1, 4, 7 and 8 (six parts).



29 The back legs slot on each side. Now glue the feet to the plinth.



30 Finally push out the 8 ribs and lay them out in size order.



31 Glue them in place following this shape (also see main photo).

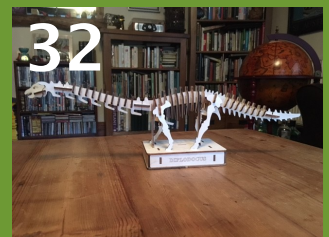

32 Congratulations! You are finished, Leave Dippy to dry overnight.

© The Trustees of the Natural History Museum, London 2017. All Rights Reserved.  
Produced & distributed under licence by Apples to Pears Ltd., Stroud, U.K. [www.applestopears.com](http://www.applestopears.com)  
PLEASE KEEP THESE INSTRUCTIONS FOR FUTURE REFERENCE  
RECOMMENDED AGE 6+ ADULT ASSISTANCE MAY BE REQUIRED.



**⚠ WARNING CHOKING HAZARD** Small parts, not suitable for children under 3 yrs.

Keep adhesive away from eyes and protect skin. Do not swallow or inhale. If adhesive enters eyes do not rub, wash with plenty of clean water. Wash skin with soap and water. Seek medical advice if any irritation develops or persists.